

# Complete Seating Systems

SEE TABLE OF CONTENTS ON FOLLOWING PAGE



# SEATING SYSTEM: TABLE OF CONTENTS

**PLEASE FILL IN ALL APPROPRIATE FORMS COMPLETELY**

PATIENT DIMENSIONS	35
*ALL ORDERS MUST INCLUDE THIS FORM*	
SEAT & BACK DIMENSIONS	36
*PLEASE FILL IN FOR TORSO PAD AND HIP GUIDES ORDERS*	
<b>CUSTOM SEATS</b>	
-SOLID	37
-WEDGE	37
-I-MODIFICATON	37
-T-MODIFICATION	37
-ANTI-THRUST	37
-CONTOURED	37
<b>CUSTOM BACKS</b>	
-SOLID	38
-I-MODIFICATON	38
-T-MODIFICATION	38
-I-MODIFICATION W/HEADREST HARDWARE EXTENSION	38
-BI-ANGULAR	38
-3 PLAIN BI-ANGULAR	38
-CURVED	38
-I-MODIFICATION CURVED	38
-CONTOURED	38
CUSTOM ABDUCTOR	39
HIP PADS	39
HARDWARE ATTACHMENTS	40-41

## SEATING SYSTEM ORDER FORM

COMPANY NAME:	
PHONE #:	
P.O. #:	
PATIENT NAME:	
CHAIR MAKE:	
MODEL:	
CONSTRUCTION OF CHAIR WIDTH:	
CHAIR DEPTH:	
BACK HEIGHT:	

TYPE OF HEADREST	
	STANDARD
	WHITMYER
	OTTO BOCK
	OTHER
	CONTOURED PAD
	SMALL PAD
	COMBINATION PAD
	LARGE PAD
	HEAD-SUPPORT ADJUSTABLE RDI COLLAR
	SMALL, OCCIPITAL RING
	LARGE, OCCIPITAL RING
	SWING AWAY MOUNTING

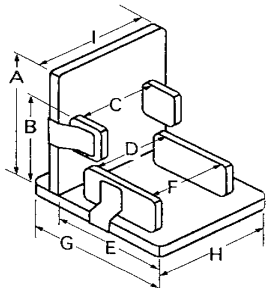
BACK & SEAT DIMENSIONS			
			
A.		F.	
B.		G.	
C.		H.	
D.		I.	
E.			

ABDUCTOR/MEDIAL THIGH		HIP/LATERAL THIGH	
	WEDGE PAD		OVAL HIP PADS
	OVAL PAD		STRAIGHT HIP PADS
	SWING AWAY MOUNTING		CONTOURED HIP PADS
			ADDUCTOR PADS



9408 GULFSTREAM RD  
FRANKFORT, IL 60423

**TOLL FREE:**  
888-928-7297

**PHONE:**  
815-464-3575 EXT.201

**FAX:**  
815-464-3576

www.richardsonproducts.com

ANTERIOR TRUNK SUPPORT	
	RIGID (OCCIPITAL RING)
	CHEST HARNESS
LATERAL TORSO SUPPORT	
	SLIDE AWAY MOUNTING
	SWING AWAY MOUNTING
PELVIS	
	SUBBASIS BAR
	SEAT BELT

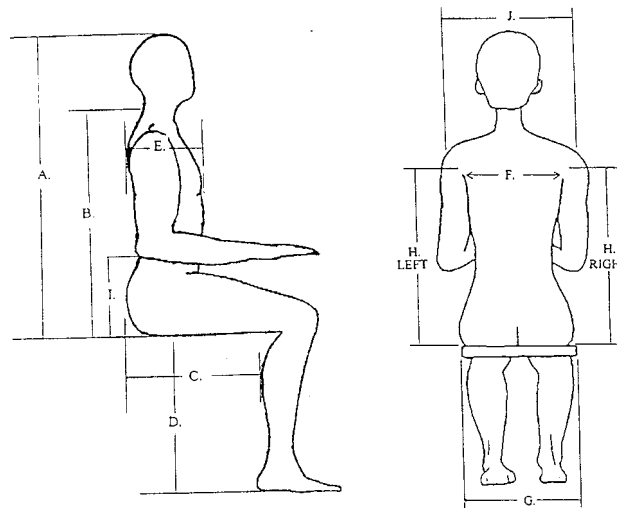

**MEASUREMENTS**

A. Seat to top of head \_\_\_\_\_

B. Seat to top of shoulder \_\_\_\_\_

C. Calf to buttocks:  
Left \_\_\_\_\_  
Right \_\_\_\_\_

D. Leg length:  
Left \_\_\_\_\_  
Right \_\_\_\_\_

E. Chest depth \_\_\_\_\_

F. Chest width \_\_\_\_\_

G. Hip width \_\_\_\_\_

H. Seat to axilla:  
Left \_\_\_\_\_  
Right \_\_\_\_\_

I. Seat to elbow \_\_\_\_\_

J. Shoulder width \_\_\_\_\_

## SEATS

### HR FOAM WITH 1/2" WOOD BASE & VINYL COVER

SOLID SEAT

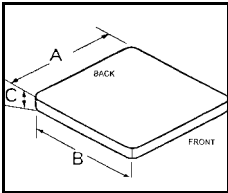

WEDGE SEAT

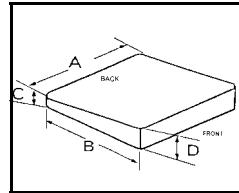

I-MODIFICATION SEAT

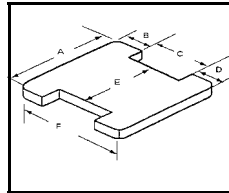

**TYPE OF SEAT:**

**NOTES:**

INDICATE BY CIRCLING:  
A. BETWEEN RAILS  
B. ON TOP OF RAILS

---

---

---

---

---

---

---

---

---

---

T-MODIFICATION SEAT

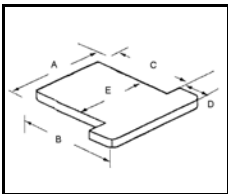

ANTI-THRUST SEAT

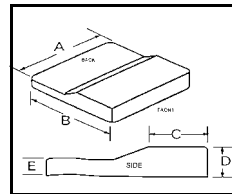

CONTOURED SEAT

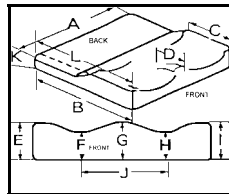

MEASUREMENTS:

- A. \_\_\_\_\_ G. \_\_\_\_\_
- B. \_\_\_\_\_ H. \_\_\_\_\_
- C. \_\_\_\_\_ I. \_\_\_\_\_
- D. \_\_\_\_\_ J. \_\_\_\_\_
- E. \_\_\_\_\_ K. \_\_\_\_\_
- F. \_\_\_\_\_ L. \_\_\_\_\_

## BACKS

### HR FOAM WITH 1/2" WOOD BASE & VINYL COVER

SOLID BACK

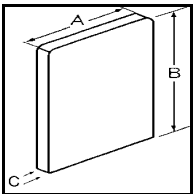

I-MODIFICATION BACK

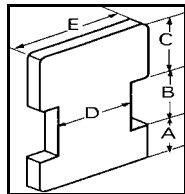

T-MODIFICATION BACK

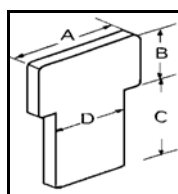

I-MODIFICATION BACK W/HEADREST HARDWARE EXTENSION

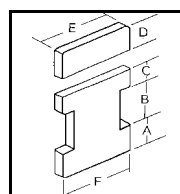

BI-ANGULAR BACK

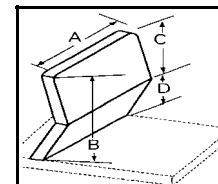

**TYPE OF BACK:**

INDICATE BY CIRCLING:  
A. BETWEEN RAILS  
B. IN FRONT OF RAILS

MEASUREMENTS:

- A. \_\_\_\_\_
- B. \_\_\_\_\_
- C. \_\_\_\_\_
- D. \_\_\_\_\_
- E. \_\_\_\_\_
- F. \_\_\_\_\_

3 PLANE BI-ANGULAR BACK

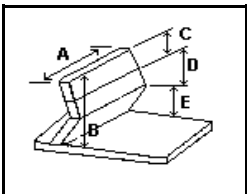

CURVED BACK

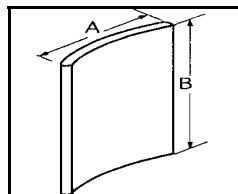

I-MODIFICATION CURVED BACK

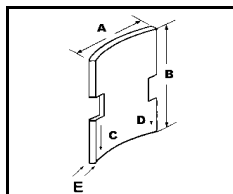

CONTOURED BACK

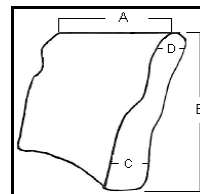

9408 GULFSTREAM RD  
FRANKFORT, IL 60423

**TOLL FREE:**  
888-928-7297

**PHONE:**  
815-464-3575  
EXT.201

**FAX:**  
815-464-3576

www.richardsonproducts.com

## SEATS

### HR FOAM WITH 1/2" WOOD BASE & VINYL COVER

<u>SOLID SEAT</u>	
PART #	DESCRIPTION:
0610001	14" CHAIR & NARROWER WITH T-NUTS
0610002	15"-19" CHAIR WITH T-NUTS
0610003	20" CHAIR AND WIDER WITH T-NUTS
<u>WEDGE SEAT</u>	
PART #	DESCRIPTION:
0610010	14" CHAIR & NARROWER WITH T-NUTS
0610011	15"-19" CHAIR WITH T-NUTS
0610012	20" CHAIR AND WIDER WITH T-NUTS
<u>I-MODIFICATION SEAT</u>	
PART #	DESCRIPTION:
0610013	14" CHAIR & NARROWER WITH T-NUTS
0610014	15"-19" CHAIR WITH T-NUTS
0610015	20" CHAIR AND WIDER WITH T-NUTS
<u>T-MODIFICATION SEAT</u>	
PART #	DESCRIPTION:
0610016	14" CHAIR & NARROWER WITH T-NUTS
0610017	15"-19" CHAIR W/ T-NUTS
0610018	20" CHAIR & WIDER WITH T-NUTS
06100161	14" X 14" CHAIR & NARROWER WITH T-NUTS
06100171	16" X 16" CHAIR & NARROWER WITH T-NUTS
06100172	18" X 18" CHAIR WITH T-NUTS
06100181	20" X 18" CHAIR WITH T-NUTS

<u>ANTI-THRUST SEAT</u>	
PART #	DESCRIPTION:
061004	14" CHAIR & NARROWER WITH T-NUTS
061005	15"-19" CHAIR WITH T-NUTS
061006	20" CHAIR AND WIDER WITH T-NUTS
<u>CONTOURED SEAT</u>	
PART #	DESCRIPTION:
061007	14" CHAIR & NARROWER WITH T-NUTS
061008	15"-19" CHAIR WITH T-NUTS
061009	20" CHAIR AND WIDER WITH T-NUTS

**Check off which size of seat and type of seat you are ordering. Also, check off anything you need in the modification check list.**

<u>MODIFICATION CHECK LIST</u>	
PART #	DESCRIPTION
0627	SPECIAL CUTOUT EACH
0626	HDPE BASE
0618	T-NUTS 10/PKG
0638	ADDITIONAL HR FOAM (PER 1" THICKNESS)
06403	CUSTOM ALTERATIONS EACH
0639	ETHAFOAM (PER 1" THICKNESS)
06253	ADDITIONAL HEIGHT GREATER THAN 22"



9408 GULFSTREAM RD  
FRANKFORT, IL 60423

**TOLL FREE:**  
888-928-7297  
**PHONE:**  
815-464-3575  
EXT.201  
**FAX:**  
815-464-3576

[www.richardsonproducts.com](http://www.richardsonproducts.com)

<u>COVERS</u>	
PART #	DESCRIPTION
0632	RUBATEX
06321	DARTEX

<u>VISCO IN BACK (PER 1" THICKNESS)</u>	
PART #	DESCRIPTION
058011	YELLOW
058012	PINK
058013	BLUE
058014	GREEN

**BACKS****HR FOAM WITH 1/2" WOOD BASE & VINYL COVER**

<b>SOLID BACK</b>	
PART #	DESCRIPTION:
0625	14" CHAIR & NARROWER WITH T-NUTS
062501	15"-19" CHAIR WITH T-NUTS
062502	20" CHAIR AND WIDER WITH T-NUTS
<b>I-MODIFICATION BACK</b>	
PART #	DESCRIPTION:
06258	14" CHAIR & NARROWER WITH T-NUTS
062510	15"-19" CHAIR WITH T-NUTS
062511	20" CHAIR AND WIDER WITH T-NUTS
<b>T-MODIFICATION BACK</b>	
PART #	DESCRIPTION:
062512	14" CHAIR & NARROWER WITH T-NUTS
062513	15"-19" CHAIR WITH T-NUTS
062514	20" CHAIR AND WIDER WITH T-NUTS
<b>I-MODIFICATION BACK W/HEADREST HARDWARE EXTENSION</b>	
PART #	DESCRIPTION:
06254	14" CHAIR & NARROWER WITH T-NUTS
06256	15"-19" CHAIR WITH T-NUTS
06257	20" CHAIR AND WIDER WITH T-NUTS
<b>BI-ANGULAR BACK</b>	
PART #	DESCRIPTION:
0631	14" CHAIR & NARROWER WITH T-NUTS
063102	15"- 19" CHAIR W/ T-NUTS
063103	20" CHAIR & WIDER WITH T-NUTS
063101	HINGED BACK 14" CHAIR & NARROWER WITH T-NUTS
063104	HINGED BACK 15"- 19" CHAIR W / T-NUTS
063105	HINGED BACK 20" CHAIR & WIDER WITH T-NUTS

<b>3 PLANE BI-ANGULAR BACK</b>	
PART #	DESCRIPTION:
063106	14" CHAIR & NARROWER WITH T-NUTS
063107	15"-19" CHAIR WITH T-NUTS
063108	20" CHAIR AND WIDER WITH T-NUTS
<b>CURVED BACK</b>	
PART #	DESCRIPTION:
0640	14" CHAIR & NARROWER WITH T-NUTS
06401	15"-19" CHAIR WITH T-NUTS
06402	20" CHAIR AND WIDER WITH T-NUTS
<b>I-MODIFICATION CURVED BACK</b>	
PART #	DESCRIPTION:
064001	14" CHAIR & NARROWER WITH T-NUTS
064011	15"-19" CHAIR WITH T-NUTS
064021	20" CHAIR AND WIDER WITH T-NUTS
<b>CONTOURED BACK</b>	
PART #	DESCRIPTION:
062591	14" AND SMALLER CHAIRS
06259	15"-19" CHAIRS
062592	20" & WIDER



9408 GULFSTREAM RD  
FRANKFORT, IL 60423

**TOLL FREE:**  
888-928-7297  
**PHONE:**  
815-464-3575 EXT.201  
**FAX:**  
815-464-3576  
www.richardsonproducts.com

Check off which size of back and type of back you are ordering. Also, check off anything you need in the modification check list.

<b>MODIFICATION CHECK LIST</b>		
PART #	DESCRIPTION	
0627	SPECIAL CUTOUT EACH	
0626	HDPE BASE	
0618	T-NUTS 10/PKG	
0638	ADDITIONAL HR FOAM (PER 1" THICKNESS)	
06403	CUSTOM ALTERATIONS EACH	
0639	ETHAFOAM (PER 1" THICKNESS)	
06253	ADDITIONAL HEIGHT GREATER THAN 22"	

<b>FOAM</b>			
[IN PLACE SYSTEM 1/2" PLYWOOD, 1/2" SUNMATE 4" THICK COVER SPECIFY THICKNESS]			
PART #	DESCRIPTION	PART #	DESCRIPTION
06414	FIP MODIFICATION	06411	KIT WITH BOWL
06415	EXTRA ZIPPER POCKET IN CUSHION	06412	INTRODUCTORY KIT WITH BAG
0641	KIT WITH BAG	06413	INTRODUCTORY KIT WITH BOWL



# ORDER FORM ACCESSORIES

<u>ATTACHED HARDWARE</u>		
(4) DROP HOOKS (4) SWIVEL LOCKS (4) SPACERS (2) REAR MOUNTING UNIVERSALS		
<input checked="" type="checkbox"/>	PART #	SIZE
	050404	0"
	050605	1"
	050705	2"
	050805	3"
<u>UNATTACHED HARDWARE</u>		
(4) DROP HOOKS (4) SWIVEL LOCKS (4) SPACERS (2) REAR MOUNTING UNIVERSALS		
<input checked="" type="checkbox"/>	PART #	SIZE
	050405	0"
	050606	1"
	050706	2"
	050906	3"

<u>HEADREST PADS</u>		
<input checked="" type="checkbox"/>	PART #	DESCRIPTION
	053509	SMALL
	053510	COMBINATION
	05351101	LARGE
	0535081	3 PIECE
	053508	SMALL CONTOURED
	053507	LARGE CONTOURED

<u>HEADREST HARDWARE</u>		
<input checked="" type="checkbox"/>	PART #	DESCRIPTION
	053501	OFFSET
	053502	PEDIATRIC OFFSET

<u>ATTACHED HARDWARE</u>		
(4) J HOOKS (4) 90 DEGREE ANGLES (4) SWIVEL LOCK, SCREWS/NUTS (2) REAR MOUNTING UNIVERSALS		
<input checked="" type="checkbox"/>	PART #	DESCRIPTION
	0501501	2 HOLE
	0501511	4 HOLE
	0501521	6 HOLE
	0501531	8 HOLE
<u>UNATTACHED HARDWARE</u>		
(4) J HOOKS (4) 90 DEGREE ANGLES (4) SWIVEL LOCK, SCREWS/NUTS (2) REAR MOUNTING UNIVERSALS		
<input checked="" type="checkbox"/>	PART #	DESCRIPTION
	05015	2 HOLE
	050151	4 HOLE
	050152	6 HOLE
	050153	8 HOLE

<u>FOOT BOXES W/ATTACHMENT HARDWARE</u>		
<input checked="" type="checkbox"/>	PART #	DESCRIPTION
	052703	SMALL
	052704	MEDIUM
	052705	LARGE
	052706	EXTRA LARGE

<u>TWO PIECE FOOT BOXES W/ATTACHMENT HARDWARE</u>		
<input checked="" type="checkbox"/>	PART #	DESCRIPTION
	052713	SMALL
	052714	MEDIUM
	052715	LARGE
	022716	EXTRA LARGE

# ORDER FORM ACCESSORIES

<b>SHOE HOLDERS, PAIR</b>		
	PART #	DESCRIPTION
<input checked="" type="checkbox"/>	05261	EXTRA SMALL
<input type="checkbox"/>	0526104	SMALL
<input type="checkbox"/>	05262	MEDIUM
<input type="checkbox"/>	05263	LARGE

<b>POSITIONING BELTS NON-PADDED</b>		
	PART #	DESCRIPTION
<input checked="" type="checkbox"/>	05352241	48"
<input type="checkbox"/>	05352242	60"

<b>POSITIONING BELTS PADDED FOUR POINTS</b>		
	PART #	DESCRIPTION
<input checked="" type="checkbox"/>	05352244	1" DUAL PULL
<input type="checkbox"/>	0535224	2" DUAL PULL
<input type="checkbox"/>	053522441	1" DUAL PULL
<input type="checkbox"/>	05352243	1-1/2" DUAL PULL
<input type="checkbox"/>	05352245	1-1/2" CENTER PULL
<input type="checkbox"/>	05352246	2" CENTER PULL

<b>POSITIONING BELTS PADDED TWO POINTS</b>		
	PART #	DESCRIPTION
<input checked="" type="checkbox"/>	05352247	1-1/2" DUAL PULL
<input type="checkbox"/>	05352249	1-1/2" CENTER PULL
<input type="checkbox"/>	05352248	1-1/2" DUAL PULL

<b>FOOT POSITIONERS</b>		
	PART #	DESCRIPTION
<input checked="" type="checkbox"/>	0526304	SMALL
<input type="checkbox"/>	0526303	MEDIUM
<input type="checkbox"/>	0526302	LARGE

<b>FEMALE CHEST HARNESS (4 BUCKLES SEWN ON HARNESS)</b>		
	PART #	DESCRIPTION
<input checked="" type="checkbox"/>	0535229	SMALL
<input type="checkbox"/>	0535230	MEDIUM
<input type="checkbox"/>	0535231	LARGE

<b>FEMALE CHEST HARNESS (4 BUCKLES SEWN HARNESS, 2 BUCKLES SEWN ON STRAP)</b>		
	PART #	DESCRIPTION
<input checked="" type="checkbox"/>	0535227	SMALL
<input type="checkbox"/>	0535222	MEDIUM
<input type="checkbox"/>	0535226	LARGE

<b>MALE CHEST HARNESS (4 BUCKLES SEWN HARNESS)</b>		
	PART #	DESCRIPTION
<input checked="" type="checkbox"/>	0535232	EXTRA SMALL
<input type="checkbox"/>	0535233	SMALL
<input type="checkbox"/>	0535234	MEDIUM
<input type="checkbox"/>	0535235	LARGE

<b>MALE CHEST HARNESS (4 BUCKLES SEWN HARNESS, 2 BUCKLES SEWN ON STRAP)</b>		
	PART #	DESCRIPTION
<input checked="" type="checkbox"/>	0535228	EXTRA SMALL
<input type="checkbox"/>	0535223	SMALL
<input type="checkbox"/>	0535220	MEDIUM
<input type="checkbox"/>	0535221	LARGE

<b>TORSO PADS, EACH</b>		
	PART #	DESCRIPTION
<input checked="" type="checkbox"/>	052610	SMALL
<input type="checkbox"/>	052611	MEDIUM
<input type="checkbox"/>	052612	LARGE
<input type="checkbox"/>	05261113	CUSTOM PAD

# VINYL COLORS



Royal  
0640PN - 52



Space Blue  
0640PN - 40



Regimental Blue  
0640PN - 51



Imperial Blue  
0640PN - 76



Crocus  
0640PN - 102



Tomato  
0640PN - 91



American Beauty  
0640PN - 88



Raspberry  
0640PN - 71



Black  
0640PN - 29



Goldenrod  
0640PN - 106



Sun Yellow  
0640PN - 89



Rose  
0640PN - 63



Regatta  
0640PN - 104



Dusty Jade  
0640PN - 75



Forest  
0640PN - 74



Green Mint II  
0640PN - 92



Blue Ridge  
0640PN - 78



Peach  
0640PN - 62



Mandarin Orange  
0640PN - 87



Bone  
0640PN - 56

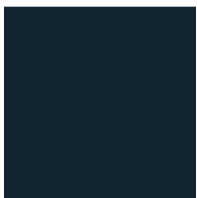

Blackberry  
0640PN - 68



Claret  
0640PN - 45



Burgundy  
0640PN - 72



Plum  
0640PN - 70



Maue  
0640PN - 64

**Richardson**  
PRODUCTS INC.  
9408 Gulfstream Road  
Frankfort, IL 60423

COLORS MAY VARY

Toll Free: 888.928.7297  
Direct: 815.464.3575 Ext. 201  
Fax: 815.464.3576  
WWW.RICHARDSONPRODUCTS.COM

# RUBATEX



Black  
0586101



Tan  
0586102



Red  
0586103



Blue  
0586104



Purple  
0586105

# DARTEX



Black  
0586112



Black  
(Rubber side out)  
0586113

COLORS MAY VARY